



137-DBB-LDA

Manual - EN

137-DBB-LDA IGM Long Drill Adapter Manual EN v1.01.01 A4ob
MAN - VZOR NÁSTROJ EN v1.02.01

IGM Long Drill Adapter for Installation of Electric Locks

Dear customer,
thank you for the confidence you have placed in us with the purchase of your new IGM jig.

This manual was prepared for the owner and operator of **IGM Long Drill Adapter for Installation of Electric Locks** to promote safety during setup, operation and maintenance. Please read carefully and understand the information contained in this manual and accompanying documents. To obtain maximum service life and performance, use the machine according to these instructions and safety guidelines. Observe work safety.

We wish you a lot of work satisfaction and joy when working with the IGM Long Drill Adapter for Installation of Electric Locks.

1. Intended Use

The long drill adapter allows drilling of longer holes through the whole width of the door for cables or electric locks etc. The adapter can only be used with a mortise jig. The adapter is fitted onto the sleeve guide of the jig. The long drill is accurately guided into the cut. The Long drill is available as a separate accessory.

1.1 Warranty

IGM always strives to deliver a high-quality and efficient product. The warranty is governed by the valid terms and conditions of IGM.

2. Product Specifications





Accessories for: IGM Mortising Jig



3. Safety

Warning! Read all instructions and safety guidelines. Failure to follow safety instructions may result in damage to the jig and serious injury to the operator. Keep the manual for future reference.

- Check the technical condition of the jig and cutting tool before work. The cutting tool must be sharp and free from damage. Do not use the jig or cutting tool when damaged.
- The working area must be clean and well-lit. There must be sufficient space around the work area.
- Take care of your safety when working. Long hair, loose clothing and jewellery may cause injury. Wear suitable work clothing, footwear and eye, ear and respiratory protection.
- Watch your hands and fingers. Always use both hands when working with the jig.
- Ensure that the jig is held securely in place. If necessary, use a clamp. Never hold the jig with your hand while working!
- Keep the jig out of reach of children and unqualified persons.
- Do not leave the jig in a damp environment and do not expose it to rain.

3.1 Symbols

	Read the manual and all instructions carefully before use.
	Wear head, ear, eye and respiratory protection.
	Use gloves.
	Warning of general danger.

 <p>MANUAL igmtools.info</p>	<p>Scan the QR code and find the manual in your language.</p>
	<p>Recycle package materials.</p>

4. Package Contents

- Drill Adapter

5. Operation

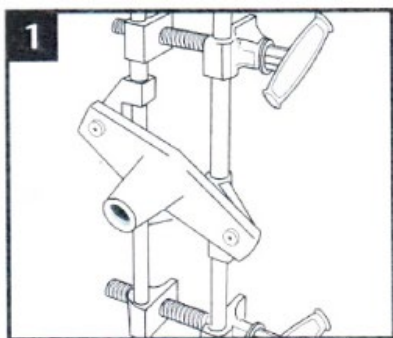

Remove Jig from door.

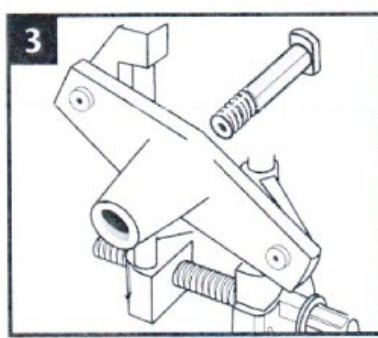

Insert bush into back of housing.

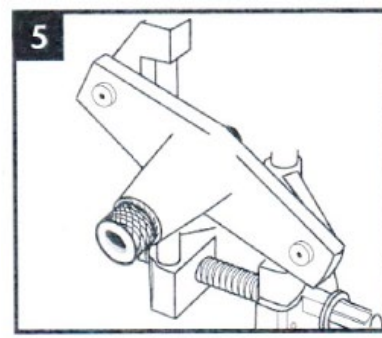

Tighten until secure.



Dismantle parts from assembly.

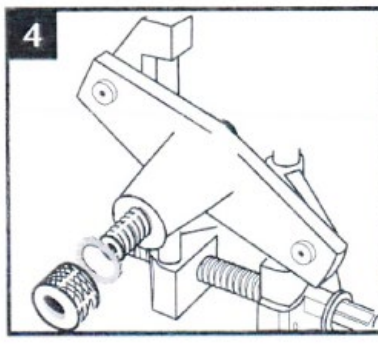

Place shakeproof washer on threaded part of knurled nut.

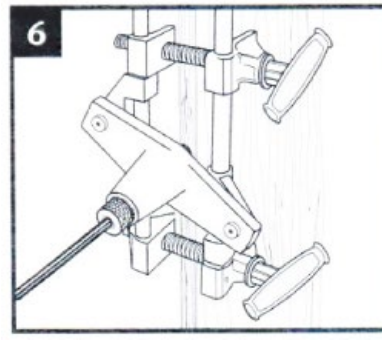

Insert drill and refit Jig to door.

6. Accessories

Recommended accessories are listed on the IGM website.

Caution! Installing unapproved accessories may cause damage to the jig and serious injury. Use only accessories recommended for this jig by IGM.